

## THE BOARDROOM

Our boardroom is located in the original main house of The Peech Hotel, with opening doors to the hotel's gardens. The room is perfect for focused meetings with big agendas – board meetings, strategy sessions, team training and creative workshops.

The room is 8m x 5m (40sqm) and is recommended for 6-16 delegates (see set-ups below). Equipped with a 65" wall-mounted TV screen with Apple Play & HDMI connections.



8 PAX

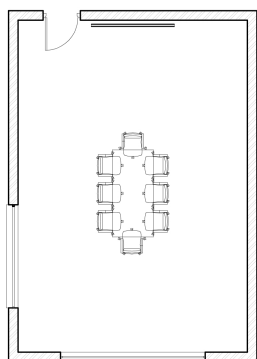

14 PAX

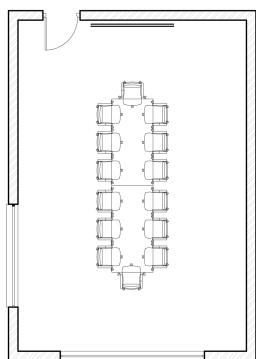

16 PAX

